

Jan. 15th, 2026

Public Notice

Public Hearing for

Rezoning in Highlands West Area

UNDER THE AUTHORITY OF THE PLANNING ACT

Reason for Hearing: A public hearing has been scheduled to review the proposed rezoning found in **Bylaw No. 884-25** for part of the Highlands West area under **Subdivision File No. 4340-25-9176**. This would rezone the affected location from "Agricultural Limited" (AL) and "Commercial Corridor" (CC) to a number of different residential, commercial, and public reserve zones. A full list of the different zones in this proposed rezoning can be found on the back of this public notice.

Affected Location: **Part of NW ¼ 25-7-3-EPM.** For a visual description of the area proposed for this zoning amendment, please see the map on the back of this notice.

Hearing Location: Niverville Community Resource & Recreation Centre
501 Centre Street
Niverville, MB

Hearing Time: Tuesday, February 17th, 2026
7:00 PM



**Scan me to
learn more!**

You can review copies of the supporting documents related to this proposed rezoning at the Town Office, located at 329 Bronstone Drive, by scanning the QR code above, or by visiting www.whereyoubelong.ca/town-services/resources/public-notice/

Anyone can attend this public hearing, and Council will hear anyone who would like to make a presentation, ask questions, or register an objection regarding this matter. If you are interested in attending or participating in this hearing in-person or by written submission, **please review all relevant public hearing procedures by scanning the QR code, by visiting the Town Office, or by visiting the link above.**

Questions? Email: planning@whereyoubelong.ca
Phone: 204-388-4600

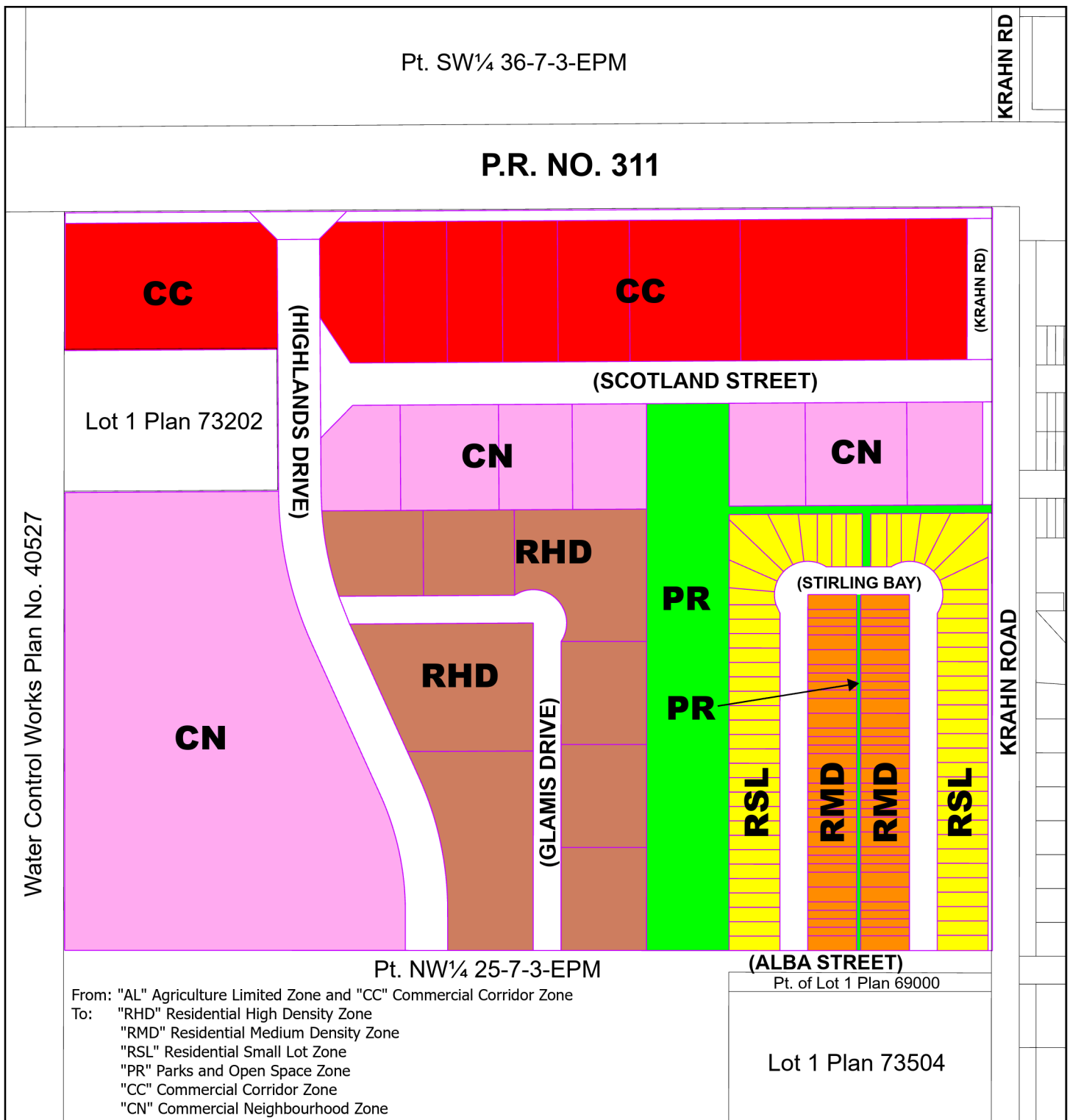

Schedule "A"

Attached to By-Law No. 884-25 of the Town of Niverville
 amending the Zoning Map of By-Law No. 795-18 Map being the
 Town of Niverville Zoning By-Law as amended

- | | |
|---|---|
| CC, Commercial Corridor Zone | Deposit Plan No. 1475/25 |
| CN, Commercial Neighbourhood Zone | Survey Parcels |
| PR, Parks and Open Space Zone | |
| RHD, Residential High Density Zone | |
| RMD, Residential Medium Density Zone | |
| RSL, Residential Small Lot Zone | |

Pt. of NW¼ 25-7-3-EPM
 in the of Town of Niverville

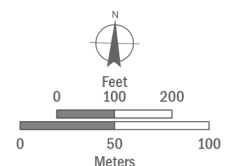

Map: 884-25 Niverville
 Date: 2025-12-09